

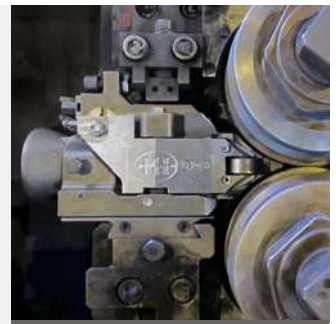

SRW-E: single-pair roller guides for finishing blocks. They have been designed for high-speed applications to ensure precise product tolerances and higher surface quality.

- > Zero-clearance system for top stability and control at high speed.
- > Pre-load on roller holder to grant higher rigidity.
- > Longer lifetime of each component to reduce operative costs.
- > Optimized V-shaped base for high reliability and repeatability of guide installation.
- > Higher guide performances thanks to the new version with a 40-mm roller.
- > Enhanced roller installation.



SRW-E
1100 GUIDE
SERIES

> entry guide <

EVOLUTION





SRW-E: single-pair roller guides for finishing blocks.
They have been designed for high-speed applications to ensure precise product tolerances and higher surface quality.



Guide type
SRW-E

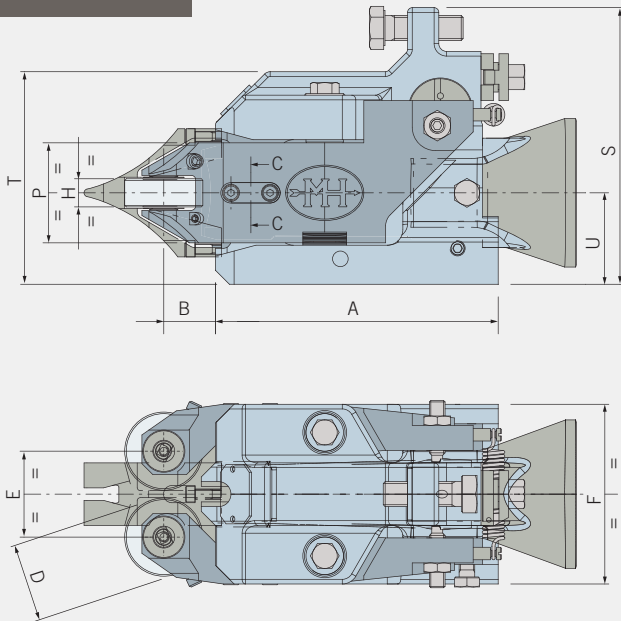

Guide type	SRW-E 18	SRW-E 24	SRW-E 30	SRW-E 40
Finishing size	Ø 5-10.5	Ø 5.5-14	Ø 10.5-21.5	Ø 20-26
Maximum oval	17 x 8.5	23.5 x 11.5	34.5 x 17	34 x 23.8
A	181	181	181	181
B	33	28	25	31.5
D max	50	58	58	60
E max	55	60	70	77
E min	36	40	50	57
F	115	115	115	115
H	18	24.4	30	40
P	64	64	64	75
S	177	177	177	177
T	136	136	136	136
U	58.5	58.5	58.5	58.5

Note: (dimensions in mm)
narrow version available with width equal to 105 mm (dimension F)

SRW-E assures precise and reliable wire rod and bar guiding up to 140 m/s both on modern delta type high-speed blocks and old 90°-blocks.

Guide features

- > Simple and heavy-duty design.
- > Stainless steel structure to resist the stress of high-speed blocks.
- > Single adjustment of each roller holder.
- > Simultaneous fine adjustment of all rollers by single central screw.
- > Independent vertical adjustment of all rollers.
- > Reduced spare parts and maintenance costs.
- > Common components for different guide types.
- > Pre-load system with special design assures the contact between ball bearings and races.
- > No supply of air/oil (for lubrication and water cooling) by external pipes.
- > Greater intervals before maintenance activities grant long operational time.
- > Guide setting on workshop and alignment on mill by standard optic devices or computerized "HiLINE".
- > Interchangeable bushes to protect guide box.
- > Optional locked roller holders to heighten rigidity.
- > Enhanced lubrication system on bearings.

Innovative DELTA-shaped sub-base

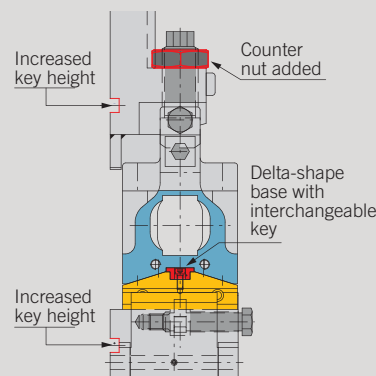

The Innovative delta-shaped sub-base design grants easy, reliable and precise guide mounting, and namely:

- > Self-centring repetitive installation.
- > Simple installation (easy scale/dust removal).
- > High stability with new key and counter nut.
- > Interchangeable key.

Closer to the rolling rings

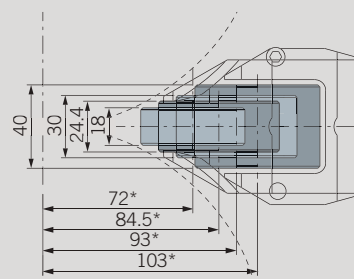

> Utilization of 18-mm rollers and nose piece to guide the stock closer to the rolling rings.
> Enhanced guide series with the new version of guide with 40-mm-height roller (SRW-E 40).

* Dimensions according to the new Danieli BGV200 mandrel